

CURVA Nº	AC	R (m)	Lc (m)	D (m)	TE/PC/PI	EC	CE	ET/PT	COORDENADAS	
									N	E
16	73° 4' 36,65"	400	40	470,173	760+2,574	762+2,574	785+12,747	787+12,747	7.785.889,124	596.589,338
17	47° 34' 48,72"	800	50	614,345	789+9,344	791+19,344	822+13,689	825+3,689	7.785.471,138	595.989,812
18	13° 31' 12,07"	1.600	50	327,550	825+14,706	828+4,706	844+12,256	847+2,256	7.784.872,935	595.910,677
19	90° 36' 25,02"	400	50	582,556	850+10,486	853+0,486	882+3,042	884+13,042	7.784.208,089	595.654,723
20	56° 54' 34,39"	400	100	227,490	887+12,591	892+12,591	904+0,081	909+0,081	7.783.958,972	596.322,835

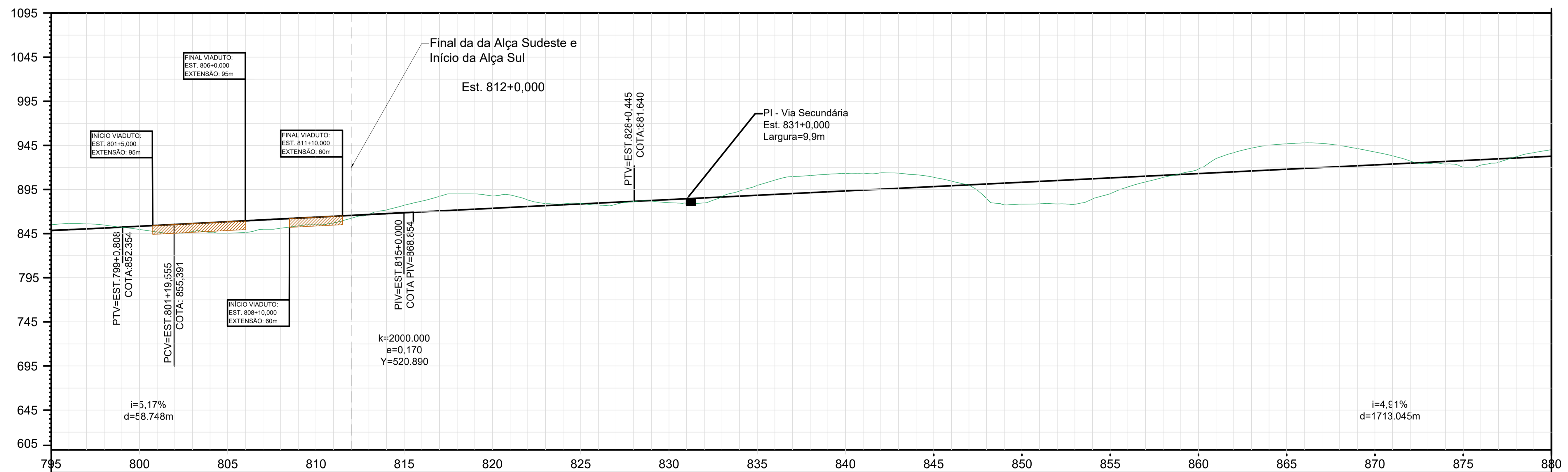

* Ver Convenções indicadas no quadro GM-02

VISTO		DATA	LOTE	TRECHO:	RODOANEL RMBH/MG	REG. Nº LOC.
10/2020				Subtrecho:	Rodoanel Região Metropolitana de Belo Horizonte	
				Segmento:	Entr. Contorno de Betim - Entr. BR-040 (Nova Lima)	
					Alça Sul	
					PROJETO GEOMÉTRICO CONCEITUAL	FOLHA:
					Planta e Perfil	GM-03