

PERFIL RMBH\_SUL

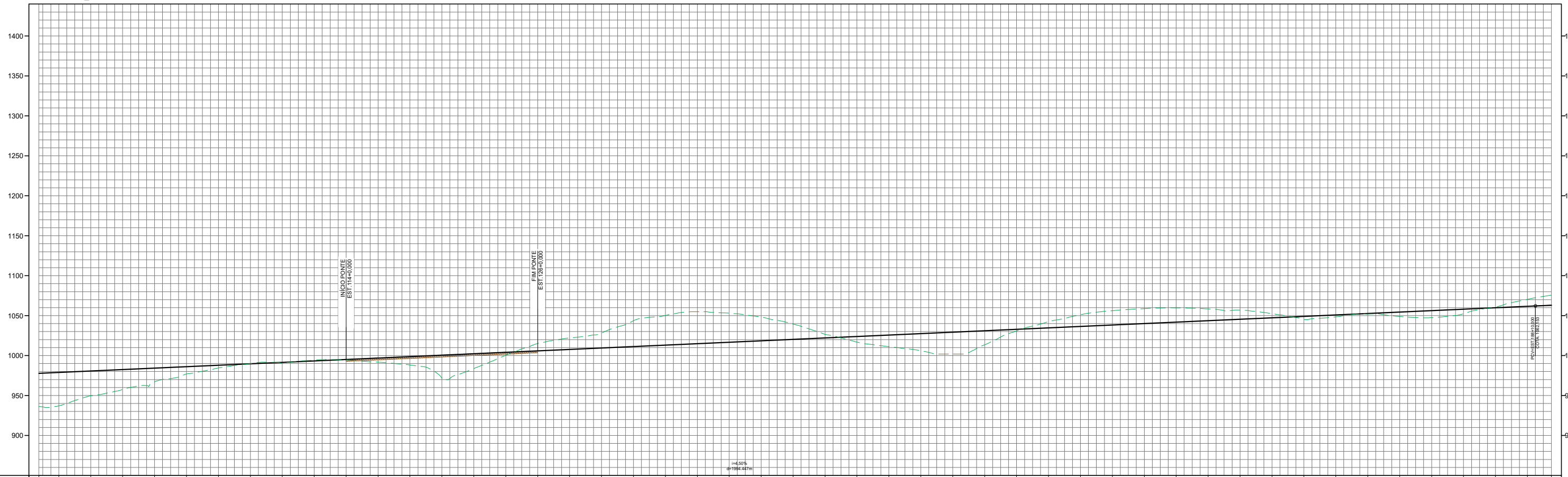

| ESTACQUEAMENTO        | 100   | 110 | 120 | 130 | 140 | 150 | 160 | 170 | 180 |  |
|-----------------------|---|-----|-----|-----|-----|-----|-----|-----|-----|--|
| COTAS TERRENO/PROJETO | 936,40<br>977,871<br>936,96<br>976,995<br>949,65<br>980,759<br>967,55<br>982,591<br>967,11<br>994,359<br>977,06<br>996,187<br>964,59<br>967,995<br>989,00<br>989,763<br>990,01<br>991,591<br>984,42<br>993,379<br>984,42<br>995,177<br>981,74<br>996,975<br>988,28<br>998,773<br>971,95<br>1009,571<br>983,79<br>1002,389<br>1009,561<br>1043,88<br>1011,359<br>1060,25<br>1013,157<br>1055,00<br>1014,956<br>1053,09<br>1016,753<br>1048,33<br>1018,551<br>1039,51<br>1020,349<br>1026,64<br>1022,147<br>1018,87<br>1023,945<br>1011,08<br>1025,743<br>1026,16<br>1027,541<br>1001,99<br>1028,339<br>1013,90<br>1031,137<br>1030,81<br>1032,935<br>1042,48<br>1034,733<br>1051,18<br>1038,531<br>1096,18<br>1038,329<br>1058,76<br>1040,127<br>1099,84<br>1041,925<br>1058,40<br>1043,723<br>1097,01<br>1045,521<br>1052,63<br>1047,319<br>1045,36<br>1049,117<br>1048,99<br>1059,915<br>1052,03<br>1052,713<br>1048,51<br>1054,512<br>1047,46<br>1056,310<br>1052,27<br>1056,108<br>1060,71<br>1059,906<br>1070,35<br>1067,704<br>1015,69<br>1063,034 |     |     |     |     |     |     |     |     |  |

| CURVA Nº | Lc (m)  | R (m)   | D (m)   | T (m)   | AC            | TE/PC/PI  | EC        | CE        | ET/PT      | POUNO | PI            |
|----------|---------|---------|---------|---------|---------------|-----------|-----------|-----------|------------|-------|---------------|
| 2        | 100,000 | 400,000 | 312,376 | 104,843 | 44° 44' 41,35 | 77+3,870  | 82+3,87   | 97+19,248 | 102+16,248 | N     | 7.782,97.238  |
| 3        | 100,000 | 400,000 | 197,676 | 100,900 | 28° 18' 54,23 | 188+5,891 | 193+5,891 | 203+3,567 | 208+3,567  | N     | 7.782,379.150 |

- NOTAS:
1. COTAS E DIMENSÕES EM METRO;
  2. IMAGEM AÉREA OBTIDA DO GOOGLE EARTH (ACESSO EM 07/2021);
  3. VER CONVENÇÕES INDICADAS NO QUADRO GM-02.

|                 |              |                  |  |                             |
|-----------------|--------------|------------------|--|-----------------------------|
|                 | REG. Nº LOC. | RODOANEL RMBH/MG | TRECHO: Rodoanel Região Metropolitana de Belo Horizonte      | ESCALA: H=1:5.000 V=1:5.000 |
|                 | VISTO        | DATA 07/2021     | LOTE   | REG. Nº LOC.                |
|                 |              |                  | SEGMENTO: Entr. Contorno de Betim - Entr. BR-040 (Nova Lima) | FOLHA: RS-GM/31             |
| PLANTA E PERFIL |              |                  |  |                             |